

## CLOSET FLANGES

### Material Specifications

- Cast iron top ring and base ring with corrosion resistant coating
- Stainless Steel Fasteners

### Design Features

- For industrial toilet installations
- Designed to secure toilet to waste piping connection and floor
- Instant Set drain pipe equipment, no hardware required
- Models with test cap eliminate the need for additional drain pipe sealing caps for inspection



### Compliance/Listings

- IAPMO 0793; IAPMO PS 97-2014e1/UPC/IPC
- Compliant to Uniform Plumbing Code (UPC®)
- Compliant to International Plumbing Code (IPC®)



PART NUMBER	DESCRIPTION
30	3" X 2" Closet Ring
30TC	3" X 2" Closet Ring w/Test Cap
40SL	4" X 2" Slotted Closet Ring
40TCSL	4" X 2" Slotted Closet Ring w/Test Cap
44	4" X 4" Deep Closet Ring
46	4" X 6" Deep Closet Ring
OS40	4" X 2" Closet Ring with 3/4" Offset, front/back or side/side

Content matter is subject to change at any time. It is the user's responsibility to ensure the most updated revisions are obtained. Rev A 4/2021

## INSTALLATION

1. Position Frank Pattern closet flange assembly over drain pipe and secure to floor with appropriate size flat head screws.
2. Instant Set closet rings clamp on outside of drain pipe.
3. Evenly tighten bolts (E) evenly until drain is secure, 20 in-lbs., max.
4. After Leak Testing drain system, cut-out exposed rubber seal using utility knife. Models with test cap only.
5. Install Toilet per manufactures instructions

PART NUMBER	NOMINAL DRAIN PIPE SIZE	DRAIN CONNECTOR	A	B	C	D
30	3"	Instant Set	4-5/8	2-1/8	6-7/8	5-3/4
30TC	3"	Instant Set	4-5/8	2-1/8	6-7/8	5-3/4
40SL	4"	Instant Set	5-1/2	2-1/16	7-1/16	5-3/4
40TCSL	4"	Instant Set	5-1/2	1-7/8	7-1/16	6
44	4"	Instant Set	5-1/2	3-3/8	7	5-3/4
46	4"	Instant Set	5-1/2	4-3/4	7-1/8	5-7/8
OS40	4"	Instant Set	5-1/2	2-1/8	7-11/16 x 7	5-3/4

Top View

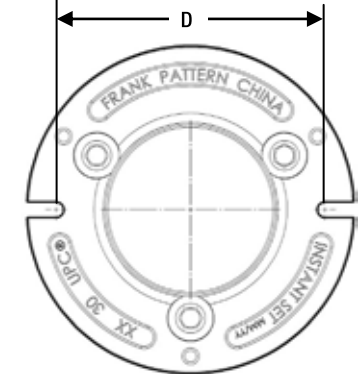

Side View

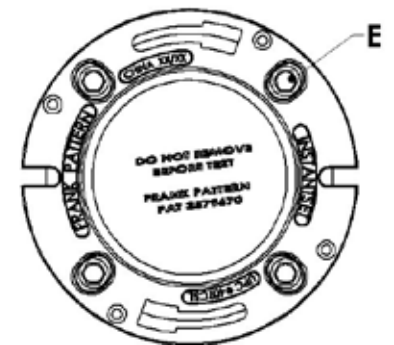
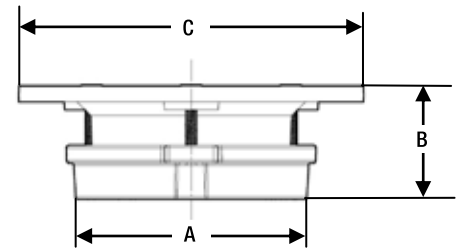

Product Submittal	
Job Name:	Date:
Part Number:	Quantity:
Architect:	
Contractor:	

Content matter is subject to change at any time. It is the user's responsibility to ensure the most updated revisions are obtained. Rev A 4/2021