

## MINI ICE MAKER BOX



### SPECIFICATIONS

Furnish and install Mini Ice Maker Box as manufactured by LSP.

### DESIGN FEATURES

- Molded from high impact plastic
- Adjustable faceplate accommodates up to 1.2" wall thickness
- Available without hammer arrestor or with before hammer arrestor, quarter-turn brass ball valve

### COMPLIANCES/LISTINGS

- IAPMO listed to ASME A112.18.1/CSA B125.1, File 4577
- IAPMO listed to ANSI/NSF 61, IAPMO File N-6614
- IAPMO listed to Lead Free Plumbing Law, File 6545
- Water Hammer Versions are IAPMO listed to ASSE 1010, File 4393

### DIMENSIONS

#### FRONT VIEW

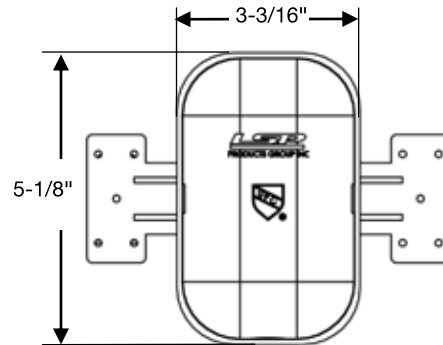

#### SIDE VIEW

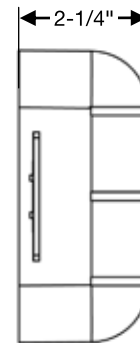

#### FACEPLATE

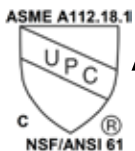
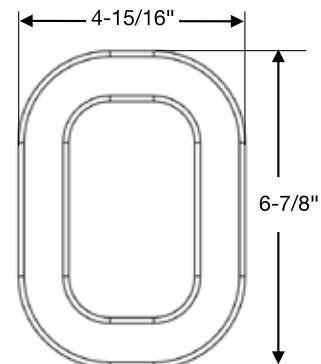

ASSE 1010



LEAD FREE



**WITHOUT HAMMER ARRESTOR VALVES**

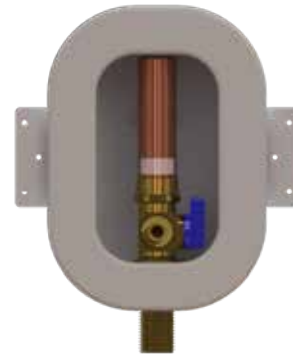

**WITH HAMMER ARRESTOR VALVES**

Part Number	Description	MSTR CTN QTY
<b>Without Valve</b>		
OB-8000	No Valve	10
<b>With Copper Sweat Valve</b>		
OB-8010-LL	White, 1/2" Copper Sweat x 1/4" Compression	10
<b>With CPVC Valve</b>		
OB-8020-LL	White, 1/2" CPVC x 1/4" Compression	10
<b>With Crimp PEX Valve</b>		
OB-8030-LL	White, 1/2" PEX x 1/4" Compression	10
OB-8031-LL	White, 3/8" PEX x 1/4" Compression	10
<b>With UPONOR ProPEX® Valve</b>		
OB-8040-LL	White, 1/2" UPONOR ProPEX® x 1/4" Compression	10
<b>With Rehau Valve</b>		
OB-8050-LL	White, 1/2" Rehau x 1/4" Compression	10
<b>With Viega Valve</b>		
OB-8070-LL	White, 1/2" Viega x 1/4" Compression	10

Part Number	Description	MSTR CTN QTY
<b>With Copper Sweat Valve</b>		
OB-8110-LL	White, 1/2" Copper Sweat x 1/4" Compression	10
<b>With CPVC Valve</b>		
OB-8120-LL	White, 1/2" CPVC x 1/4" Compression	10
<b>With Crimp PEX Valve</b>		
OB-8130-LL	White, 1/2" PEX x 1/4" Compression	10
<b>With UPONOR ProPEX® Valve</b>		
OB-8140-LL	White, 1/2" UPONOR ProPEX® x 1/4" Compression	10
<b>With Rehau Valve</b>		
OB-8150-LL	White, 1/2" Rehau x 1/4" Compression	10
<b>With Viega Valve</b>		
OB-8170-LL	White, 1/2" Viega x 1/4" Compression	10

\*Add "-T" to the end of any part number for Tract Pack (faceplates packaged separately)

Product Submittal	
Job Name:	Date:
Part Number:	Quantity:
Architect:	
Contractor:	

Content matter is subject to change at any time. It is the user's responsibility to ensure the most updated revisions are obtained. Rev C 2/2021