

TALON CLAMP



Part Number	Description	A	B	C
P-40429	3/8" CTS	3/4"	3/8"	7/8"
P-40433*	1/2" CTS	1"	3/8"	1"
P-40434*	3/4" CTS	1-1/4"	3/8"	1-1/2"
P-40435	1" CTS	1-1/2"	1/2"	1-3/4"
P-40436	1-1/4" CTS	1-3/4"	1/2"	2-1/8"
P-40460	1/2" & 3/4" CTS	1-1/4"	3/8"	1-1/2"

**While supplies last*

SPECIFICATION

Furnish and install Talon Clamp as manufactured by LSP.

DESIGN FEATURES

- Made of HDPE material
- Fast and easy to use
- Pre-installed barbed nail prevents backout
- Clips on tubing prior to nailing
- P-40460 will work with both 1/2" and 3/4" CTS tubing, only needing one clamp
- Black in color

DIMENSIONS

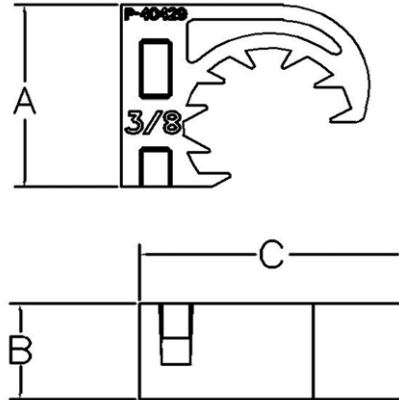

COMPLIANCES/LISTINGS

- IAPMO File # 5822



Product Submittal	
Job Name:	Date:
Part Number:	Quantity:
Architect:	
Contractor:	

Content matter is subject to change at any time. It is the user's responsibility to ensure the most updated revisions are obtained. Rev 4 7/2024