

## ESCUTCHEON



Part Number	Nominal Size	OD (A)	ID (B)	Thickness (C)
ve P-08405	1/2" IPS	2.473	0.845	0.426
ve P-08406	1/2" CTS	2.473	0.630	0.426
ve P-08407	3/4" CTS	2.473	0.880	0.426
ve P-08408	3/4" IPS	2.473	1.055	0.426
ve P-08410	1" CTS	2.874	1.130	0.435
ve P-08411	1" IPS	2.870	1.320	0.571
ve P-08415	1 1/2" IPS	3.228	1.905	0.681
ve P-08420	2" IPS	3.465	2.380	0.570

### DESIGN FEATURES

Add a finishing touch to the area around protruding pipes, while covering the opening in the wall or floor. These white, one-piece, slip-on escutcheons will not disrupt compression connections. CTS and IPS available in a variety of sizes.

### MATERIAL SPECIFICATIONS

- Polypropylene, white

### DIMENSIONS

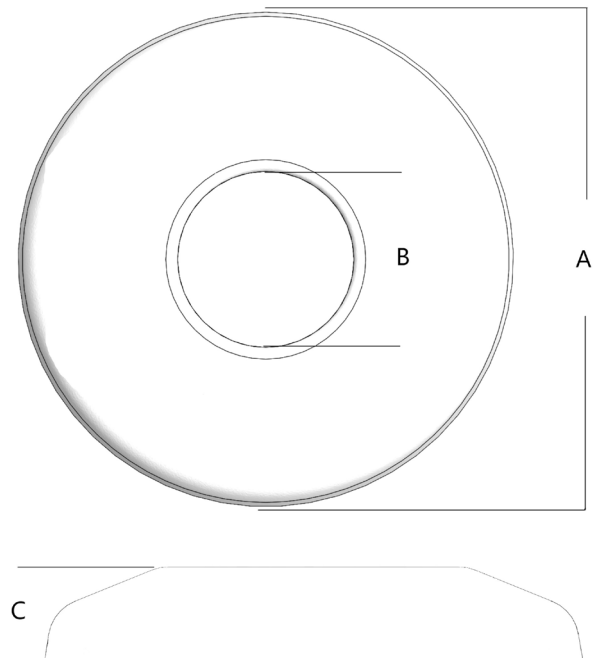

Product Submittal	
Job Name:	Date:
Part Number:	Quantity:
Architect:	
Contractor:	

Content matter is subject to change at any time. It is the user's responsibility to ensure the most updated revisions are obtained. 02/2024